

**VALVE711**

3/4" Thermostatic Valve

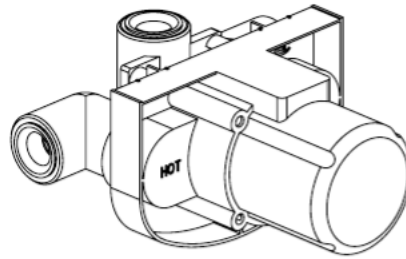

**STANDARDS**

- Compliant with ASME A112.18.1 B125.1 when sold with external trim
- Certified by or IAPMO R&T Lab when sold with external

**FEATURES**

Thermo control cartridge  
 1/2" NPT connections  
 Flows 9.6 GPM @ 60 PSI  
 Step-By-Step Installation Instructions  
 Limited Lifetime Warranty  
 Includes Test Plug

**DIMENSIONS**

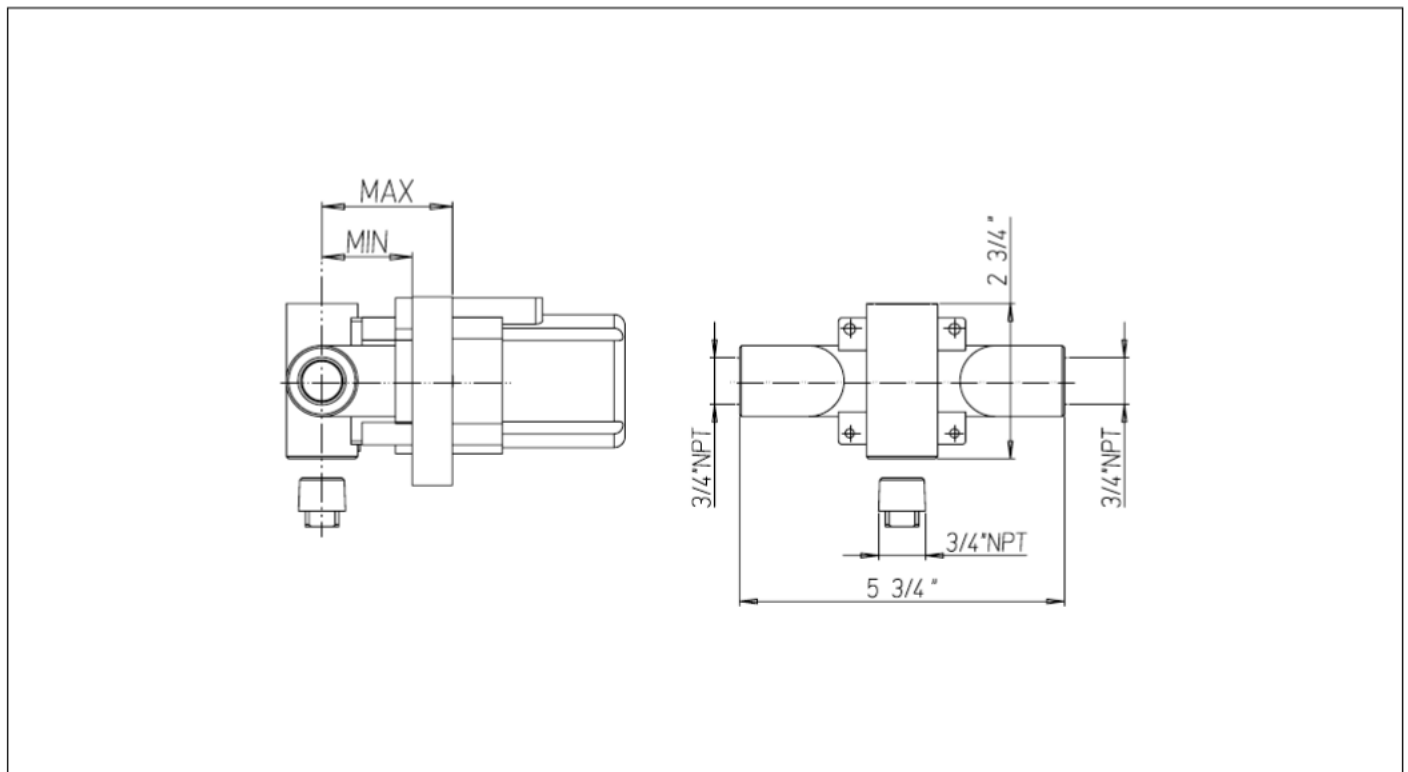

Project \_\_\_\_\_  
 Contractor \_\_\_\_\_