

series  
*Quadro*



**CR**



CHROME

**PW**



BRUSHED  
NICKEL

**OK**



MATT GOLD  
PVD

**BL**



MATT BLACK  
PVD



CERAMIC CARTRIDGE

### QU..211

Single handle lavatory faucet with lever handle.  
6.7/16" overall height.  
5.9/16" spout reach.  
2 3/4" maximum deck thickness.  
Pop up drain included.

Flow Rate: 1.2 GPM @ 60 PSI

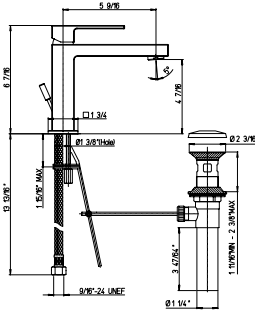

replacement cartridge  
53CC956G251FOR0EVS

### QU..211LL

Single handle tall lavatory faucet with lever handle.  
10.15/16" overall height.  
5.9/16" spout reach.  
2 3/4" maximum deck thickness.  
Push drain included.

Flow Rate: 1.2 GPM @ 60 PSI

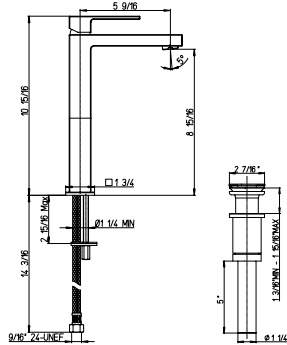

replacement cartridge  
53CC956G251FOR0EVS

### QU..208

Single-lever wall mounted mixer with plate  
9" spout reach.

Flow Rate: 1.2 GPM @ 60 PSI

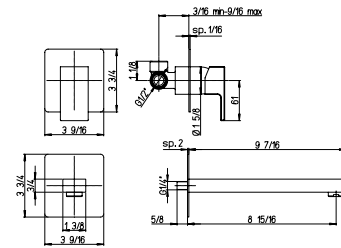

replacement cartridge  
53CC956GM

### QU..214

Widespread lavatory faucet with lever handles.  
8" centers.  
5.3/4" spout height.  
6.1/2" spout reach.  
2 3/4" maximum deck thickness.  
Push drain included.

Flow Rate: 1.2 GPM @ 60 PSI

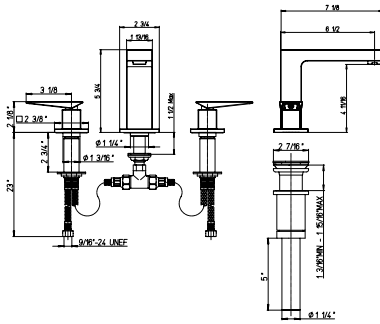

replacement valve  
53CC581XAD right  
53CC581XAS left

### QU..102

Roman tub with lever handles.  
3" spout height.  
9 3/4" spout reach.  
2 3/4" maximum deck thickness.

Flow Rate: 9.6 GPM @ 60 PSI

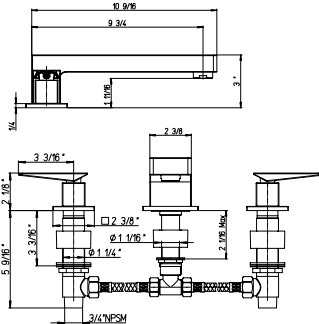

replacement valve  
53CC5813/4D right  
53CC5813/4S left

**QU..109**

Roman tub with lever handles and a diverter with hand held shower.  
 3" spout height.  
 9 3/4" spout reach.  
 2 3/4" maximum deck thickness.

Flow Rate: 9.6 GPM @ 60 PSI  
 Flow Rate and spray: 1.2 GPM @ 60 PSI

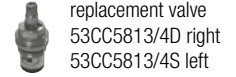
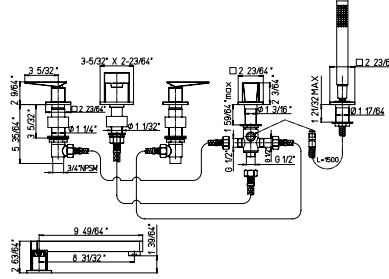

**QU..136**

Floor mounted tub filler.  
 Single Hole Free-Standing  
 Tub Filler with Hand held shower.  
 78" flexible hose.

Flow Rate: 9.6 GPM @ 60 PSI  
 Flow Rate and spray: 1.8 GPM @ 80 PSI

NEEDS ROUGH VALVE 136

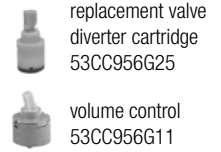
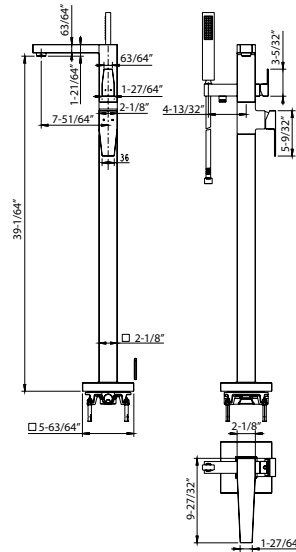

**VALVE 136**

Rough-in Valve  
 3/4" inlet connections

Flows 9.0 GPM @ 60 PSI

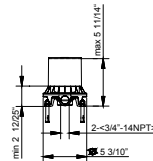

**VALVE 697**

Pressure Balance  
 Rough-in Valve  
 1/2" inlet connections

Flows 5.0 GPM @ 60 PSI

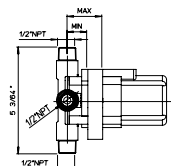

**VALVE 788**

Pressure Balance  
Rough-in Valve  
½" inlet connections

Flows 5.0 GPM @ 60 PSI

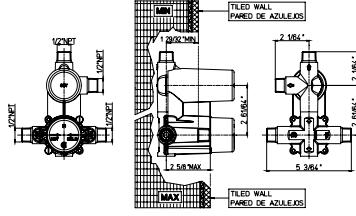
**VALVE 690**

Thermostatic Valve  
with ¾" volume control  
½" inlet connections

Flows 7.1 GPM @ 60 PSI

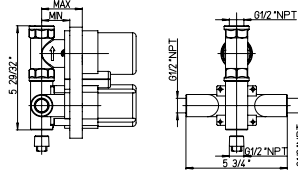
**VALVE 691**

Thermostatic Valve  
2 ways diverter cartridge  
½" inlet connections

Flows 5.5 GPM @ 60 PSI

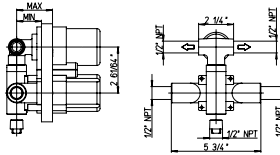

**VALVE 711**

Thermostatic Valve  
¾" inlet connections

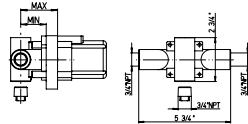
Flows 9.6 GPM @ 60 PSI

**VALVE 400**

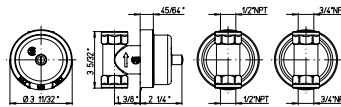
½" Volume Control  
½" inlet connections  
Flows 12.5 GPM @ 60 PSI

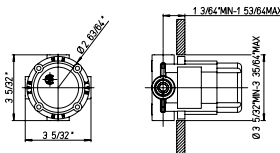

**VALVE 402**

¾" Volume Control  
¾" inlet connections  
Flows 15.0 GPM @ 60 PSI

**VALVE 425**

3 ways Diverter Rough-in Valve  
½" inlet connections

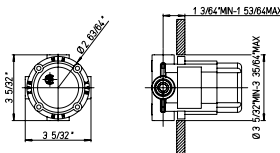
Flows 9.7 GPM @ 60 PSI



**QU..697**

Pressure balance valve shower set.

NEEDS ROUGH VALVE 697

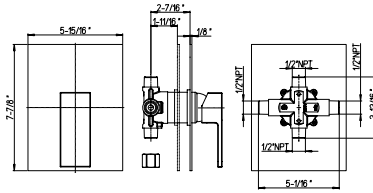

replacement cartridge  
53CC956D697VA

**QU..788**

Pressure balance valve tub and shower set.

NEEDS ROUGH VALVE 788

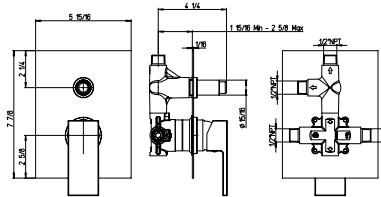

replacement cartridge  
53CC956D697VA

**QU..690**

Thermostatic valve with 3/4" ceramic disc volume control.

NEEDS ROUGH VALVE 690

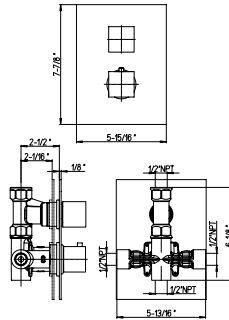

replacement ceramic disc valve  
53CC5813/4S25



replacement cartridge  
2TCC959

**QU..691**

Thermostatic valve with 2 way diverter volume control.

NEEDS ROUGH VALVE 691

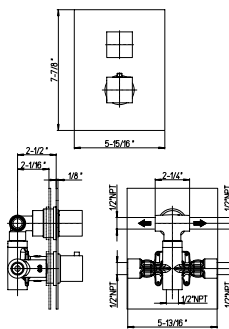

replacement ceramic disc valve  
53CC956DEV35



replacement cartridge  
2TCC959

**QU..711**

3/4" thermostatic valve only.

NEEDS ROUGH VALVE 711

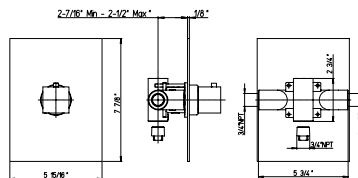

replacement cartridge  
2TCC959

**QU.400**

Volume control trim kit.

NEEDS ROUGH VALVE 400 OR 402

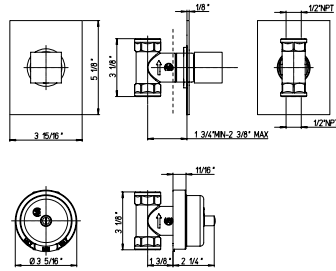

replacement ceramic disc valve  
53CC5813/4S25

**QU.425**

3 way diverter. 3/4" ceramic disc valve. 1/2" inlet connections.

NEEDS ROUGH VALVE 425

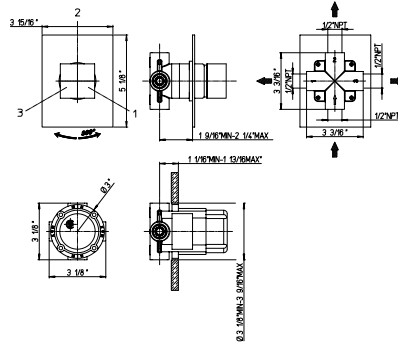

replacement diverter cartridge  
FR53CC956DRG40

**KIT 1**

Pressure balance tub & shower KIT including:  
 - 8" Brass Square rain shower head - Anti Limestone  
 - 12" Brass Square wall mounted arm & flange  
 - Trim 788 with diverter & ceramic disc valve cartridge  
 - Rough in valve 788  
 - 8 17/64" Brass tub spout  
 1/2" NPT inlet connections

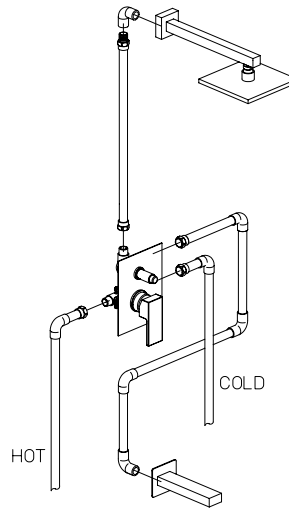

**KIT 2**

Thermostatic tub & shower KIT including:  
 - 8" Brass Square rain shower head - Anti Limestone  
 - 12" Brass Square wall mounted arm & flange  
 - Trim 691 with thermostatic valve & 2 way diverter volume control  
 - Rough in valve 691  
 - 8 17/64" Brass tub spout  
 1/2" NPT inlet connections

