

9469100

1/2" Thermostatic Trim
With Diverter And
Volume Control

needs rough VALVE 691

FINISHES

9469100PC Polished Chrome
9469100BN Brushed Nickel

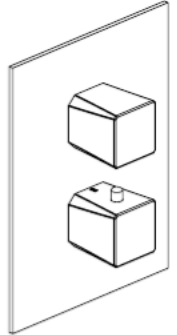

STANDARDS 

- Compliant with ASME A112.18.1 - CSA B125.1 when sold with rough valve
- Certified by IAPMO R&T Lab when sold with rough valve

FEATURES

Solid Brass Construction
Complete Trim Kit
Mechanical diverter Controlling water flow
Thermo Control Cartridge
Independent Temperature Control
Stop limit temperature device included
Step-By-Step Installation Instructions

DIMENSIONS

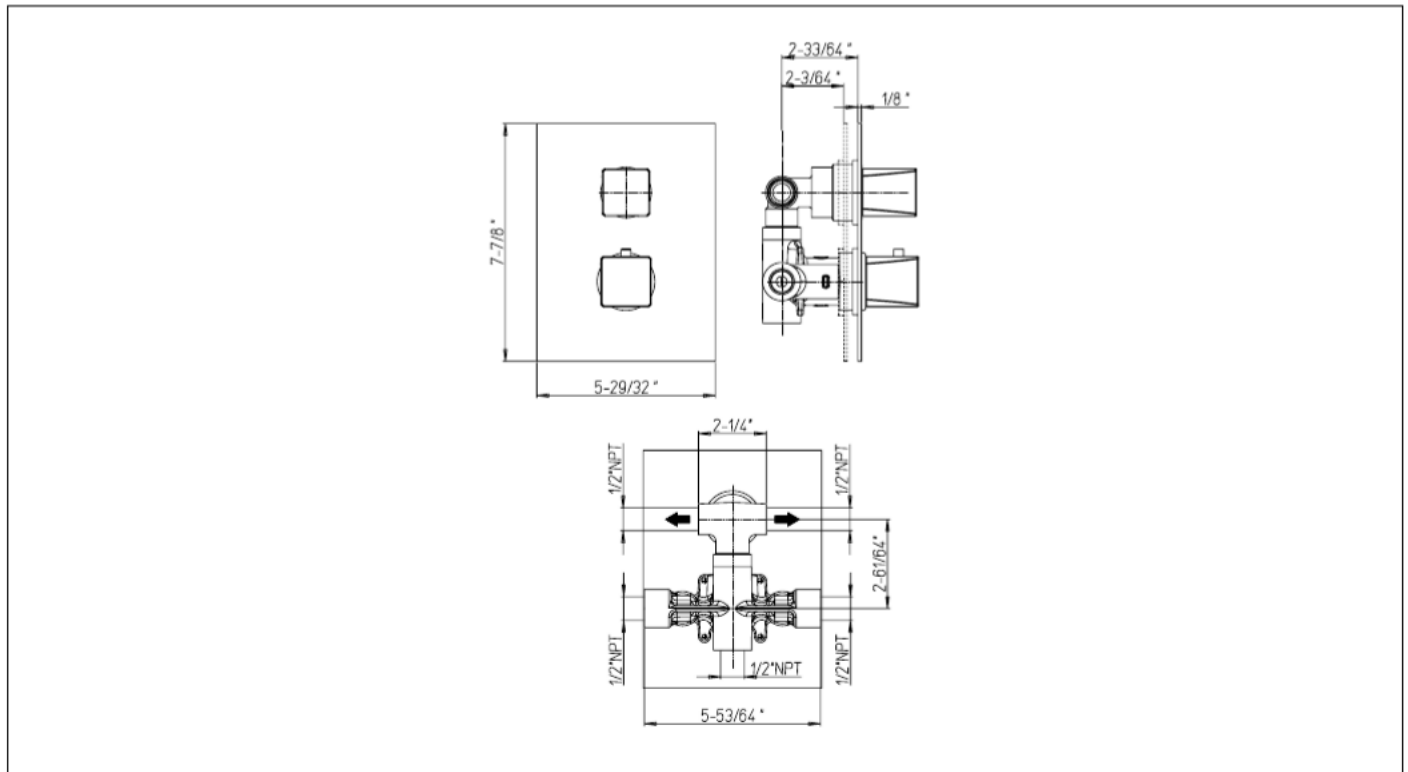

Project _____
Contractor _____