

**8470000**  
Square Handheld  
Shower Hook

**FINISHES**  
8470000PC Polished Chrome  
8470000BN Brushed Nickel  
8470000BB Brushed Black

**STANDARDS**

- Compliant with ASME A112.18.1 - CSA B125.1

**FEATURES**

Solid Brass Construction  
Step-By-Step Installation Instructions

**DIMENSIONS**

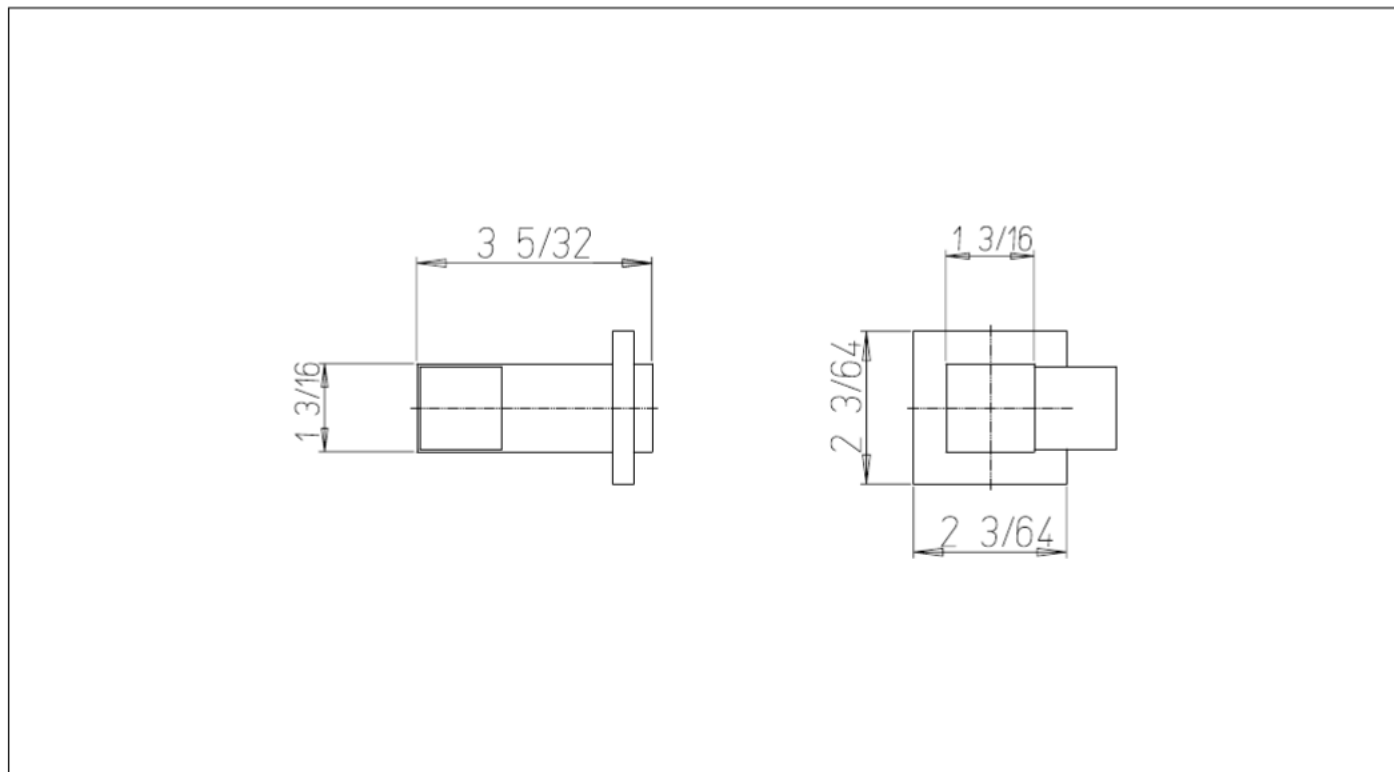

Project \_\_\_\_\_  
Contractor \_\_\_\_\_