

series
Quadro



CR



CHROME

PW



BRUSHED
NICKEL

OK



MATT GOLD
PVD

BL



MATT BLACK
PVD



QU..211

Single handle lavatory faucet with lever handle.
6.7/16" overall height.
5.9/16" spout reach.
2 3/4" maximum deck thickness.
Pop up drain included.

Flow Rate: 1.2 GPM @ 60 PSI

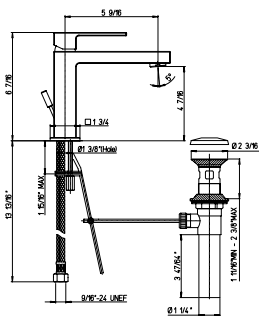

replacement cartridge
53CC956G251FOR0EVS

QUADRO

QU..211LL

Single handle tall lavatory faucet with lever handle.
10.15/16" overall height.
5.9/16" spout reach.
2 3/4" maximum deck thickness.
Push drain included.

Flow Rate: 1.2 GPM @ 60 PSI

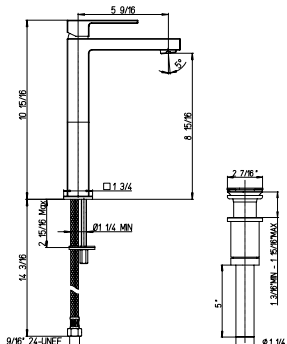

replacement cartridge
53CC956G251FOR0EVS

QU..208

Single-lever wall mounted mixer with plate
9" spout reach.

Flow Rate: 1.2 GPM @ 60 PSI

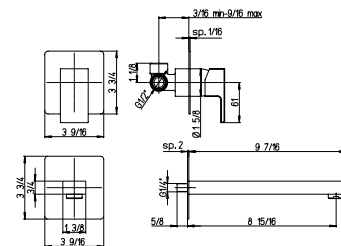

replacement cartridge
53CC956GM

QU..214

Widespread lavatory faucet with lever handles.
8" centers.
5.3/4" spout height.
6.1/2" spout reach.
2 3/4" maximum deck thickness.
Push drain included.

Flow Rate: 1.2 GPM @ 60 PSI

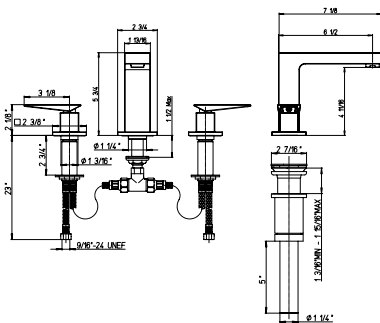

replacement valve
53CC581XAD right
53CC581XAS left

QU..102

Roman tub with lever handles.
3" spout height.
9 3/4" spout reach.
2 3/4" maximum deck thickness.

Flow Rate: 9.6 GPM @ 60 PSI

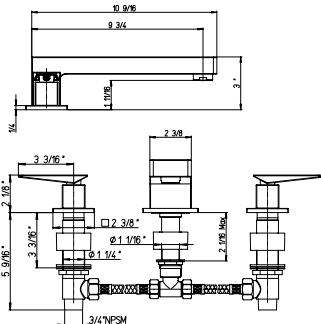
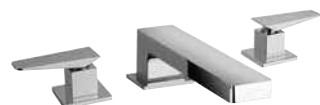

replacement valve
53CC5813/4D right
53CC5813/4S left

QU..109

Roman tub with lever handles and a diverter with hand held shower.
 3" spout height.
 9 3/4" spout reach.
 2 3/4" maximum deck thickness.

Flow Rate: 9.6 GPM @ 60 PSI
 Flow Rate and spray: 1.2 GPM @ 60 PSI

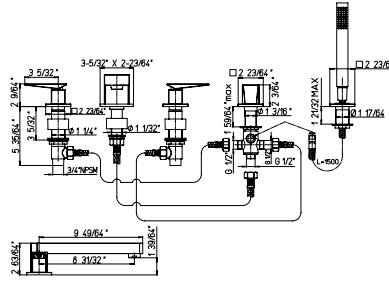
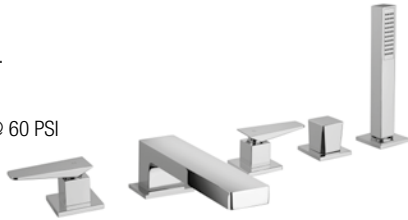

replacement valve
 53CC5813/4D right
 53CC5813/4S left

QU..136

Floor mounted tub filler.
 Single Hole Free-Standing
 Tub Filler with Hand held shower.
 78" flexible hose.

Flow Rate: 9.6 GPM @ 60 PSI
 Flow Rate and spray: 1.8 GPM @ 80 PSI

NEEDS ROUGH VALVE 136

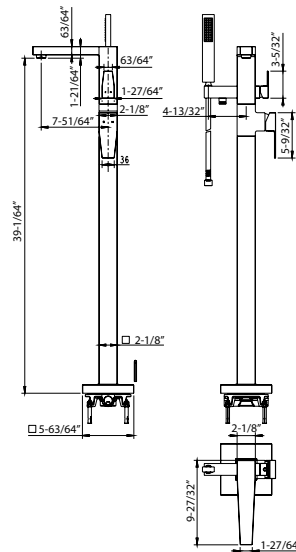
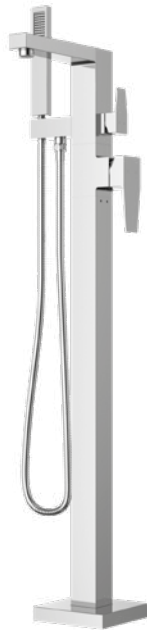

replacement valve
 diverter cartridge
 53CC956G25



volume control
 53CC956G11

VALVE 136

Rough-in Valve
 3/4" inlet connections

Flows 9.0 GPM @ 60 PSI

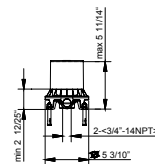

VALVE 697

Pressure Balance
 Rough-in Valve
 1/2" inlet connections

Flows 5.0 GPM @ 60 PSI

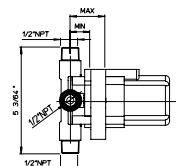

VALVE 788

Pressure Balance
Rough-in Valve
½" inlet connections

Flows 5.0 GPM @ 60 PSI

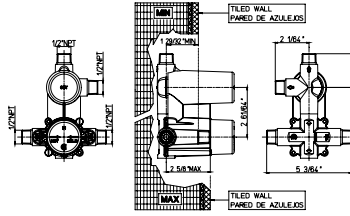
VALVE 690

Thermostatic Valve
with ¾" volume control
½" inlet connections

Flows 7.1 GPM @ 60 PSI

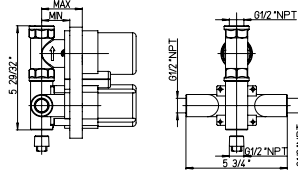
VALVE 691

Thermostatic Valve
2 ways diverter cartridge
½" inlet connections

Flows 5.5 GPM @ 60 PSI

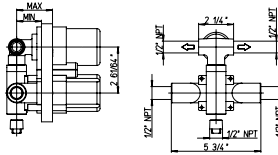

VALVE 711

Thermostatic Valve
¾" inlet connections

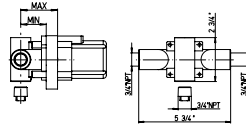
Flows 9.6 GPM @ 60 PSI

VALVE 400

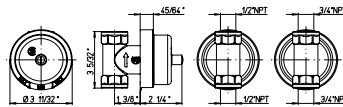
½" Volume Control
½" inlet connections
Flows 12.5 GPM @ 60 PSI

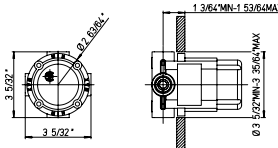

VALVE 402

¾" Volume Control
¾" inlet connections
Flows 15.0 GPM @ 60 PSI

VALVE 425

3 ways Diverter Rough-in Valve
½" inlet connections

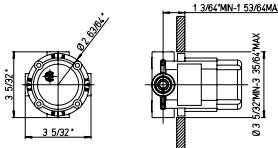
Flows 9.7 GPM @ 60 PSI



QU..697

Pressure balance valve shower set.

NEEDS ROUGH VALVE 697

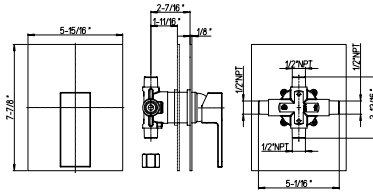

replacement cartridge
53CC956D697VA

QU..788

Pressure balance valve tub and shower set.

NEEDS ROUGH VALVE 788

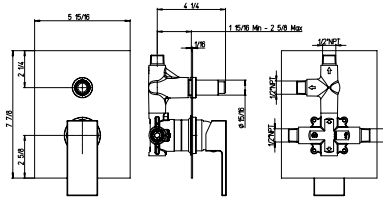

replacement cartridge
53CC956D697VA

QU..690

Thermostatic valve with 3/4" ceramic disc volume control.

NEEDS ROUGH VALVE 690

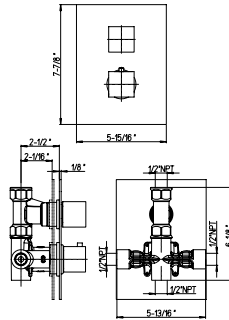

replacement ceramic disc valve
53CC5813/4S25



replacement cartridge
2TCC959

QU..691

Thermostatic valve with 2 way diverter volume control.

NEEDS ROUGH VALVE 691

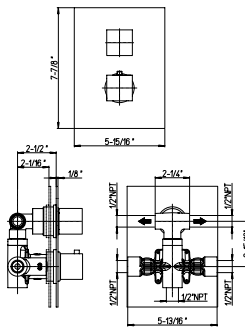
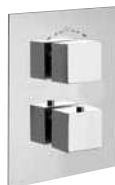

replacement ceramic disc valve
53CC956DEV35



replacement cartridge
2TCC959

QU..711

3/4" thermostatic valve only.

NEEDS ROUGH VALVE 711

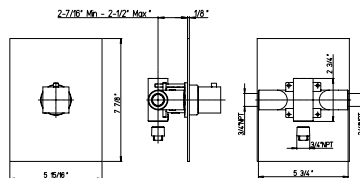

replacement cartridge
2TCC959

QU.400

Volume control trim kit.

NEEDS ROUGH VALVE 400 OR 402

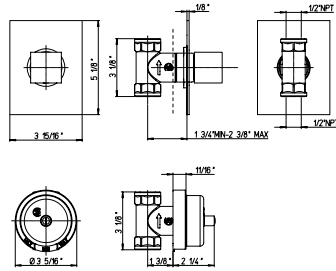

replacement ceramic disc valve
53CC5813/4S25

QU.425

3 way diverter. 3/4" ceramic disc valve. 1/2" inlet connections.

NEEDS ROUGH VALVE 425

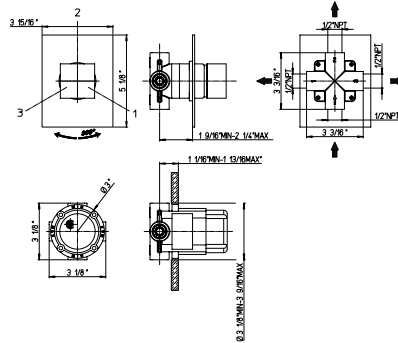

replacement diverter cartridge
FR53CC956DRG40

KIT 1

Pressure balance tub & shower KIT including:

- 8" Brass Square rain shower head - Anti Limestone
- 12" Brass Square wall mounted arm & flange
- Trim 788 with diverter & ceramic disc valve cartridge
- Rough in valve 788
- 8 17/64" Brass tub spout
- 1/2" NPT inlet connections

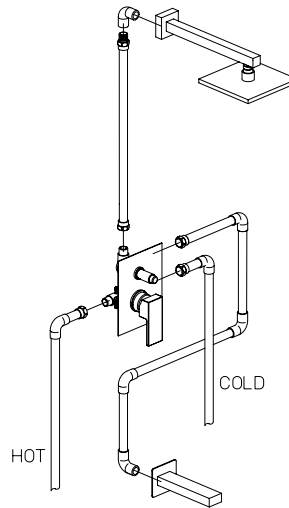
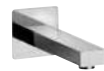

KIT 2

Thermostatic tub & shower KIT including:

- 8" Brass Square rain shower head - Anti Limestone
- 12" Brass Square wall mounted arm & flange
- Trim 691 with thermostatic valve & 2 way diverter volume control
- Rough in valve 691
- 8 17/64" Brass tub spout
- 1/2" NPT inlet connections

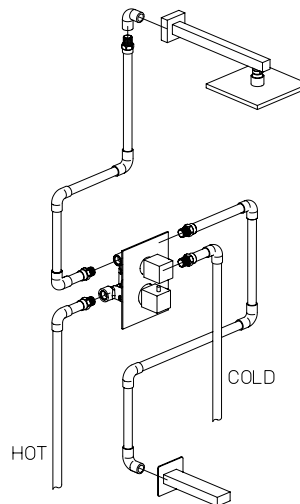

KIT 3

- Pressure balance shower KIT including:
- 8" Brass Square rain shower head - Anti Limestone
 - 12" Brass Square wall mounted arm & flange
 - Trim 697 ceramic disc valve cartridge
 - Rough in valve 697
 - 1/2" inlet connections

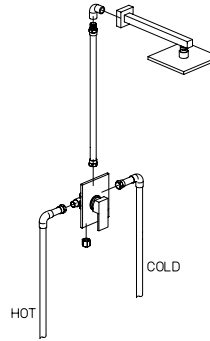
KIT 4

- Thermostatic shower KIT including:
- 8" Brass Square rain shower head - Anti Limestone
 - 12" Brass Square wall mounted arm & flange
 - Trim 690 with thermostatic valve & 3/4" ceramic disc volume control
 - Rough in valve 690
 - 1/2" inlet connections

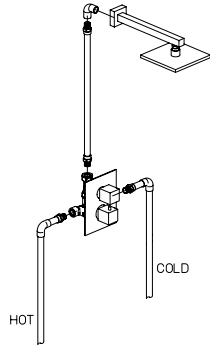
KIT 5

- Pressure balance hand shower KIT including:
- 8" Brass Square rain shower head - Anti Limestone
 - 12" Brass Square wall mounted arm & flange
 - Trim 788 with diverter & ceramic disc valve cartridge
 - Rough in valve 788
 - Square wall mounted brass handshower set including 1-jet square handshower, wall mounted bracket & supply elbow + flange, 78" flexible hose
 - 1/2" inlet connections

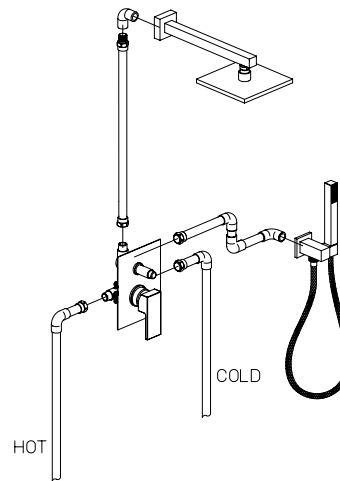
KIT 6

- Thermostatic hand shower KIT including:
- 8" Brass Square rain shower head - Anti Limestone
 - 12" Brass Square wall mounted arm & flange
 - Trim 691 with thermostatic valve & 2 way diverter volume control
 - Rough in valve 691
 - Square wall mounted brass handshower set including 1-jet square handshower, wall mounted bracket & supply elbow + flange, 78" flexible hose
 - 1/2" inlet connections

