



MILLENNIUM 2000 DOOR

ENERGY EFFICIENCY

Thermal Transmission Coefficient

$U_w \geq 2.3$ (W/m²K)

Please consult typology, dimensions and glazing.

ACCOUSTIC INSULATION

Maximum glazing: 1.18"

Maximum acoustic insulation: $R_w = 38$ dBA

CATEGORIES ACHIEVED AT TEST CENTRE

Resistance to mild impact (EN 13049)

Class 5 (máx)

Reference test door 70.87" x 86.61" / 2 sashes. Laminated glazing 3+3

SECTIONS	Frame 1.77" Sash 1.77"
PROFILE THICKNESS	Door 0.079"
MAXIMUM DIMENSIONS	Width (L) = 57.09" Height (H) = 118.11" Side hung door Width (L) = 43.31" Height (H) = 118.11" Swing door
MAXIMUM WEIGHT/SASH	180 Kg

Please consult maximum dimensions according to types.

FINISHES	Colour powder coating (RAL, mottled, rough...) According to Qualicoat > 60 microns Wood effect powder coating According to Qualideco standard Anodized According to Ewwa Euras Standard Class 15 Optionally Class 20 and 25
----------	---

EXTRUSION ALLOY	6063 T-5
GASKETS	EPDM double gasket
OPENING POSSIBILITIES	
INWARDS	Side hung
OUTWARDS	Side hung
SWING	Side hung 1 and 2 sashes

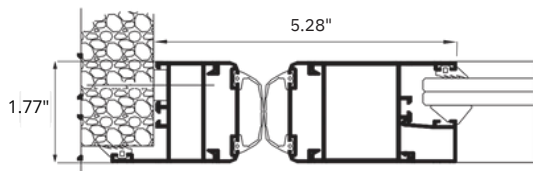

Automatic sliding version

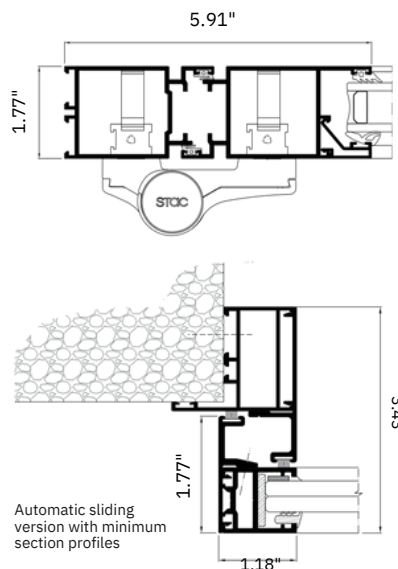

Automatic sliding version with minimum section profiles