

series
Elba



CR



CHROME

PW



BRUSHED
NICKEL

OK



MATT GOLD
PVD

BL



MATT BLACK
PVD



certified
by the U.S. Environmental Protection Agency

78..211

Single handle lavatory faucet.
 6 7/16" overall height.
 4" spout reach.
 2 3/4" maximum deck thickness.
 Deck plate & pop-up drain included.

Flow Rate: 1.2 GPM @ 60 PSI

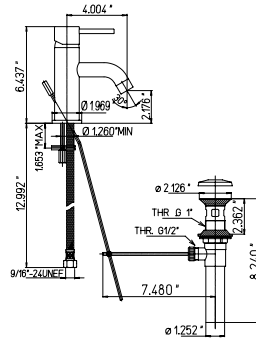

replacement cartridge
53CC956GMD

78..211LL

Single handle lavatory faucet.
 12 3/4" overall height.
 6" spout reach.
 2 3/4" maximum deck thickness.
 Deck plate & pop-up drain included.

Flow Rate: 1.2 GPM @ 60 PSI

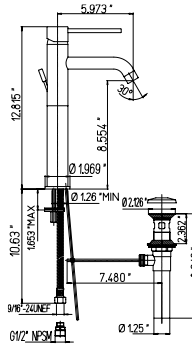

replacement cartridge
53CC956GMD

78..214

Widespread lavatory faucet.
 8" centers.
 12 3/4" overall height.
 6 1/2" spout reach. Spout rotates.
 2 3/4" maximum deck thickness.
 Pop-up drain included.

Flow Rate: 1.2 GPM @ 60 PSI

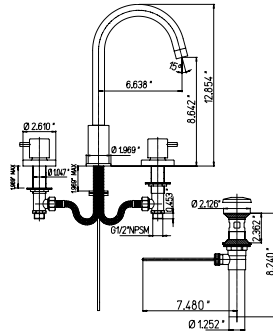

replacement valve
53CC581XAD right
53CC581XAS left

78..250

Single handle lavatory faucet.
 10 1/2" spout height.
 6 5/8" spout reach. Spout rotates.
 2 3/4" maximum deck thickness.
 Pop-up drain included.

Flow Rate: 1.2 GPM @ 60 PSI

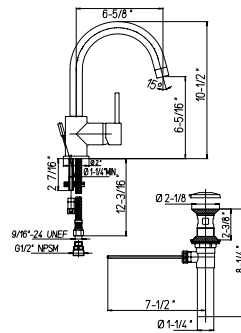

replacement cartridge
53CC956GM

78..207

Wall mount lavatory faucet.
 8" centers.
 8 1/2" spout reach.

Flow Rate: 1.2 GPM @ 60 PSI

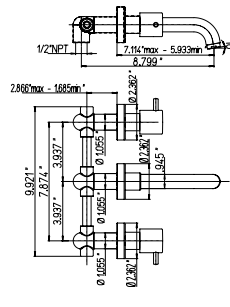

replacement valve
53CC581XAD right
53CC581XAS left

ELBA

78..102

Roman tub with lever handles.
 9" spout height.
 6" spout reach.
 2 3/4" maximum deck thickness.

Flow Rate: 9.6 GPM @ 60 PSI

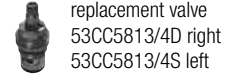
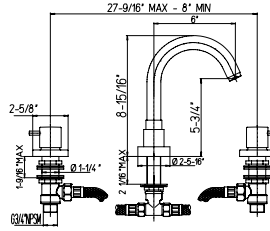

replacement valve
 53CC5813/4D right
 53CC5813/4S left

78..109

Roman tub with lever handles and diverter with hand held shower.
 9" spout height.
 6" spout reach.
 2 3/4" maximum deck thickness.

Flow Rate: 7.0 GPM @ 60 PSI
 Flow Rate and spray: 1.8 GPM @ 80 PSI

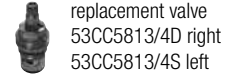
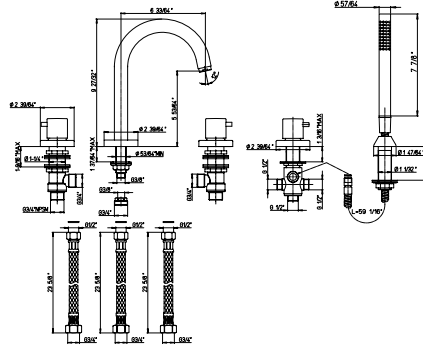

replacement valve
 53CC5813/4D right
 53CC5813/4S left

78..136

Floor mounted tub filler.
 Single Hole Free-Standing
 Tub Filler with Hand held shower.
 78" flexible hose.

Flow Rate: 7.0 GPM @ 60 PSI
 Flow Rate and spray: 1.8 GPM @ 80 PSI

NEEDS ROUGH VALVE 136

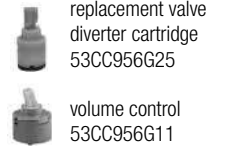
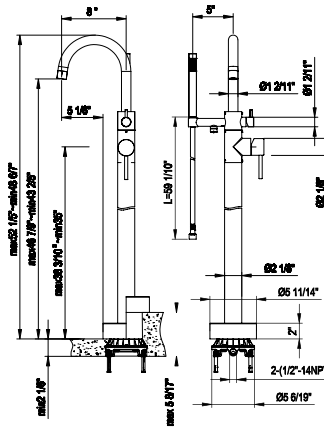

replacement valve
 diverter cartridge
 53CC956G25
 volume control
 53CC956G11

VALVE 136

Rough-in Valve
 3/4" inch inlet connections

Flows 9.0 GPM @ 60 PSI

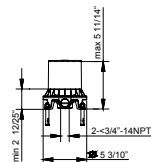

VALVE 697

Pressure Balance
 Rough-in Valve
 1/2" inch inlet connections

Flows 5.0 GPM @ 60 PSI

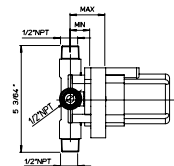

VALVE 788

Pressure Balance
Rough-in Valve
½" inch inlet connections

Flows 5.0 GPM @ 60 PSI

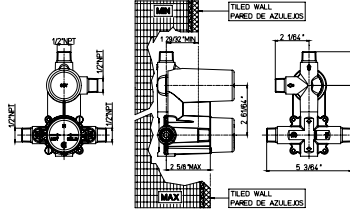
VALVE 690

Thermostatic Valve
with ¼" volume control
½" inch inlet connections

Flows 7.1 GPM @ 60 PSI

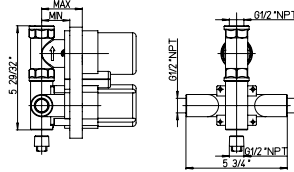
VALVE 691

Thermostatic Valve
2 ways diverter cartridge
½" inch inlet connections

Flows 5.5 GPM @ 60 PSI

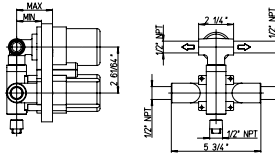

VALVE 711

Thermostatic Valve
¾" inch inlet connections

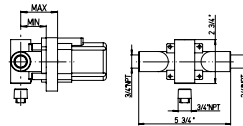
Flows 9.6 GPM @ 60 PSI

VALVE 400

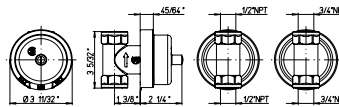
½" Volume Control
½" inch inlet connections
Flows 12.5 GPM @ 60 PSI

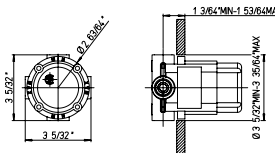

VALVE 402

¾" Volume Control
¾" inch inlet connections
Flows 15.0 GPM @ 60 PSI

VALVE 425

3 ways Diverter Rough-in Valve
½" inch inlet connections

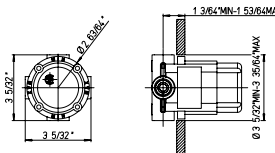
Flows 9.7 GPM @ 60 PSI



78..697

Pressure balance valve shower set.

NEEDS ROUGH VALVE 697

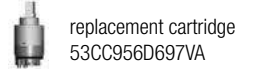
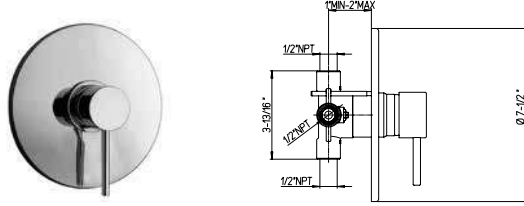

78..788

Pressure balance valve tub and shower set.

NEEDS ROUGH VALVE 788

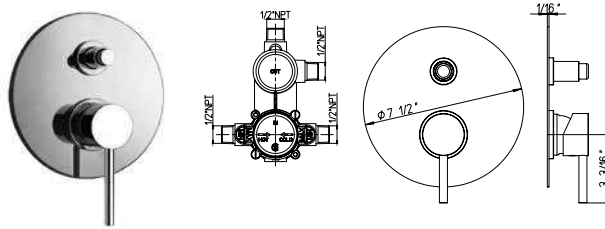

78..690

Thermostatic valve with 3/4" ceramic disc volume control.

NEEDS ROUGH VALVE 690

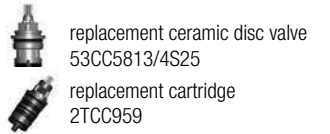
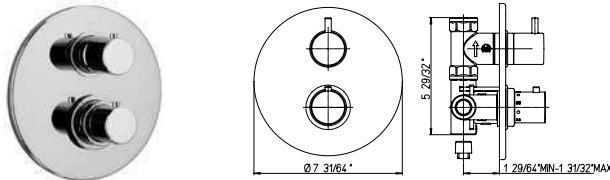

78..691

Thermostatic valve with 2 way diverter volume control.

NEEDS ROUGH VALVE 691

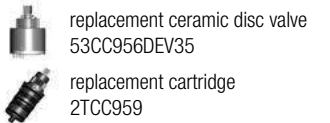
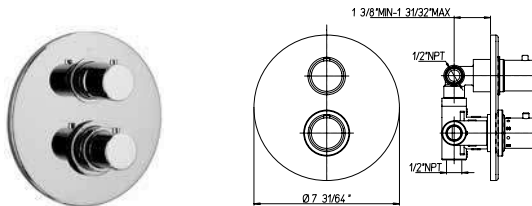

78..711

3/4" thermostatic valve only.

NEEDS ROUGH VALVE 711

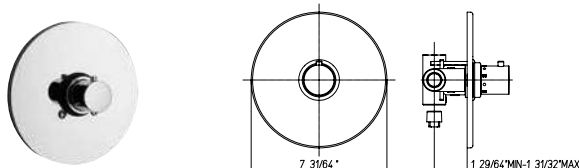

78..400

Volume control trim kit.

NEEDS ROUGH VALVE 400 OR 402

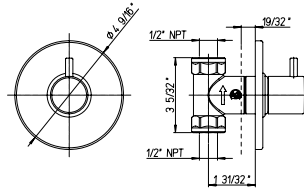

replacement ceramic disc valve
53CC5813/4S25

78..425

3 way diverter. 3/4" ceramic disc valve. 1/2" inlet connections.

NEEDS ROUGH VALVE 425

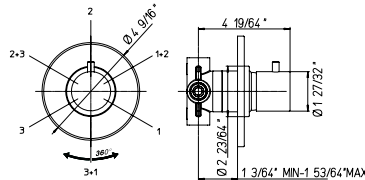

replacement diverter cartridge
53CC956DRG40

KIT 1

Pressure balance tub & shower KIT including:
 - 8" Brass round rain shower head - Anti Limestone
 - 12" Brass round wall mounted arm & flange
 - Trim 788 with diverter & ceramic disc valve cartridge
 - Rough in valve 788
 - 5 3/4" Brass tub spout
 1/2" NPT inlet connections

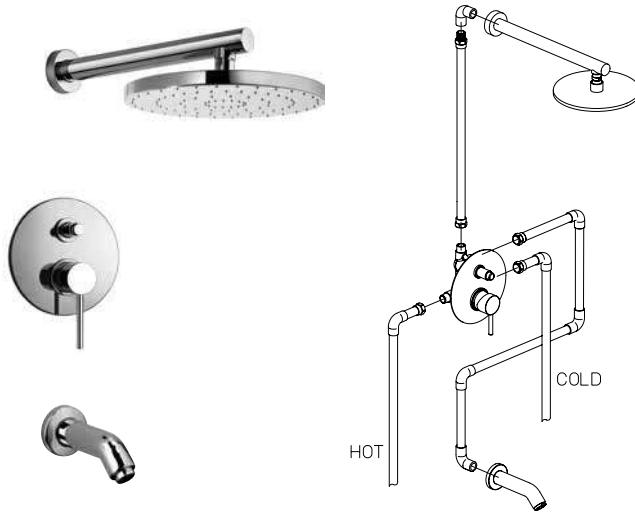

KIT 2

Thermostatic tub & shower KIT including:
 - 8" Brass round rain shower head - Anti Limestone
 - 12" Brass round wall mounted arm & flange
 - Trim 691 with thermostatic valve & 2 way diverter volume control
 - Rough in valve 691
 - 5 3/4" Brass tub spout
 1/2" NPT inlet connections

