

series
Ornellaia



CR

CHROME

PW

BRUSHED
NICKEL





Certified by
EPA

87..102

Roman tub.
 7 15/16" spout height.
 8 5/8" spout reach.
 2 3/4" maximum deck thickness.

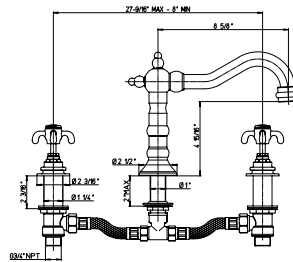
Flow Rate: 9.6 GPM @ 60 PSI





 replacement valve
 53CC5813/4D right
 53CC5813/4S left

87..109

Roman tub with diverter
 and hand held shower.
 7 15/16" spout height.
 8 5/8" spout reach.
 2 3/4" maximum deck thickness.

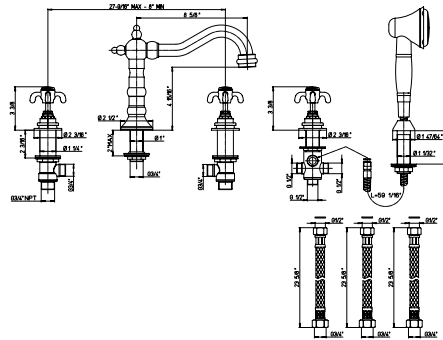
Flow Rate: 9.6 GPM @ 60 PSI



 replacement valve
 53CC5813/4D right
 53CC5813/4S left

87..136

Floor mounted tub filler.
 Single Hole Free-Standing
 Tub Filler with Hand held shower.

Flow Rate: 7.0 GPM @ 60 PSI
 Flow Rate and spray: 1.8 GPM
 @ 80 PSI

NEEDS ROUGH VALVE 136

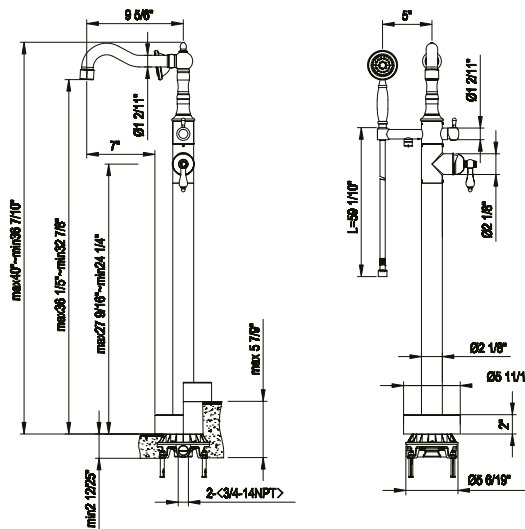

 replacement valve
 diverter cartridge
 53CC956G25

 volume control
 53CC956G11

VALVE 136

 Rough-in Valve
 3/4" inch inlet connections

Flows 9.0 GPM @ 60 PSI

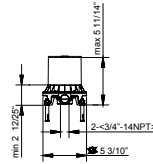
VALVE 690

 Thermostatic Valve
 with 3/4" volume control
 1/2" inch inlet connections

Flows 7.1 GPM @ 60 PSI

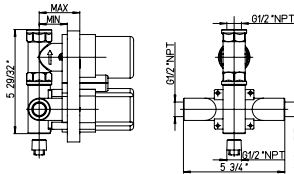

VALVE 691

 Thermostatic Valve
 2 ways diverter cartridge
 1/2" inch inlet connections

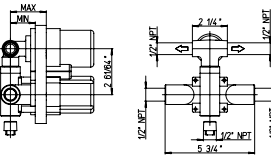
Flows 5.5 GPM @ 60 PSI

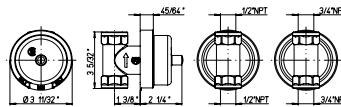

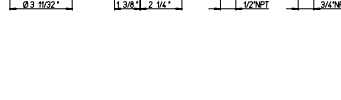
VALVE 400

 1/2" Volume Control
 1/2" inch inlet connections
 Flows 12.5 GPM @ 60 PSI

VALVE 402

 3/4" Volume Control
 3/4" inch inlet connections
 Flows 15.0 GPM @ 60 PSI

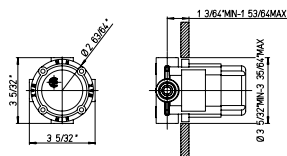
VALVE 425

 3 ways Diverter Rough-in Valve
 1/2" inch inlet connections

Flows 9.7 GPM @ 60 PSI



87..690

Thermostatic valve with 3/4" ceramic disc volume control.

NEEDS ROUGH VALVE 690

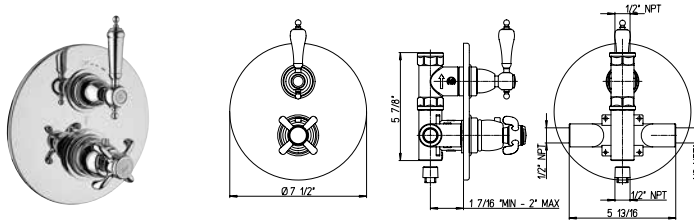

87..691

Thermostatic valve with 2 way diverter volume control.

NEEDS ROUGH VALVE 691

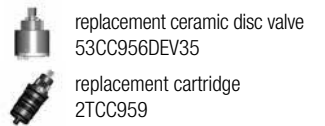
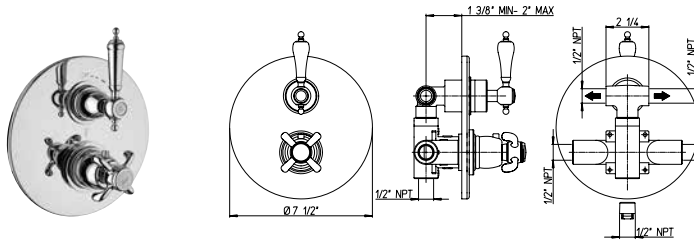

87..400

Volume control trim kit.

NEEDS ROUGH VALVE 400 OR 402

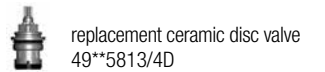
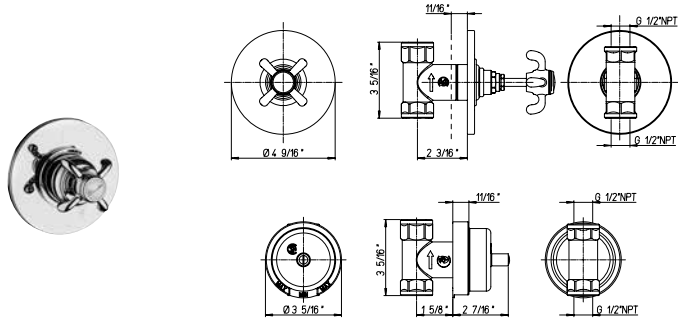

87..425

3 way diverter. 3/4" ceramic disc valve. 1/2" inlet connections.

NEEDS ROUGH VALVE 425

